

AP MORGAN



Ryton Close, Matchborough West, Redditch
Offers in excess of £115,000

Features:

- One bedroom ground-floor maisonette
- Spacious lounge
- Fitted kitchen
- One double bedroom
- Lots of integral storage
- Modern bathroom
- Versatile garden space
- Garage and an off-road parking space
- EPC-D

Description:

A well-presented ground-floor maisonette in the desirable area of Matchborough West, with lots of integral storage spaces, a spacious bedroom and lounge and a versatile garden space.

The property briefly comprises: a welcoming entrance hallway with a cloakroom, a generous lounge space with rear access, the fitted kitchen of this house offers a sink, as well as plumbing and space for free-standing amenities. The bedroom of the property is a spacious double that looks over the garden. The bathroom of the house offers a sink, bath/shower and WC.

To the rear of the property is a garden space laid to an initial slate shingle, the remaining space is laid to lawn, with mature planted borders and fenced boundaries offering gated rear access.

Situated in Matchborough West, this property is in close proximity to the town centre, offering an assortment of amenities including shopping, well regarded schooling, bars and restaurants, along with the local bus and railway stations. Additionally, the M5 and M42 motorways are easily accessible.



Details:

Hallway

Lounge 15'4" x 10'8" (4.67m x 3.25m) Both max

Kitchen 7'9" x 6'8" (2.36m x 2.03m) Both max

Bedroom 9'9" x 12'5" (2.97m x 3.78m) Both max

Bathroom 6'10" x 6'6" (2.08m x 1.98m) Both max

Garage



EPC Rating: D

Council Tax Band: A (tbc by solicitors).

Tenure: Leasehold (tbc by solicitors).

For more information or to arrange a viewing, please call us on 01527 406 956.

How can we help you?

Need a mortgage?

We recommend Wiser Mortgage Advice. They will search the market for you to ensure you get the right lender and mortgage deal. They typically achieve mortgage offers much more quickly than if you were dealing with lenders directly. The initial appointment is free and without obligation. Call us on 01527 406 956, or visit their website for more information: www.wisermortgageadvice.co.uk

Property to sell?

If you need to sell a property in order to buy, you ideally need to be on the market at least (and preferably Sold STC) before viewing, otherwise you may lose out to other buyers when the right property comes along. In these circumstances we can get your property 'live' quickly. Just book a free valuation and we will visit your property and discuss your needs.

Need a solicitor?

A good solicitor can save you literally weeks of time in the buying/selling process, reducing the stress levels of all involved. We will instruct a reputable firm that is competitive on cost and very reliable. Just ask for a quote.

Need a removal company and storage?

A professional removal company takes the stress out of moving, knowing that your belongings are safe and insured far outweighs any small savings by trying to do it yourself or using a man-and-a-van service. We work closely with and recommend Cube Removals as the leading local firm. For peace of mind and a reliable service call them on 0800 193 0000 or visit their website, cuberemovals.co.uk, to arrange a survey.

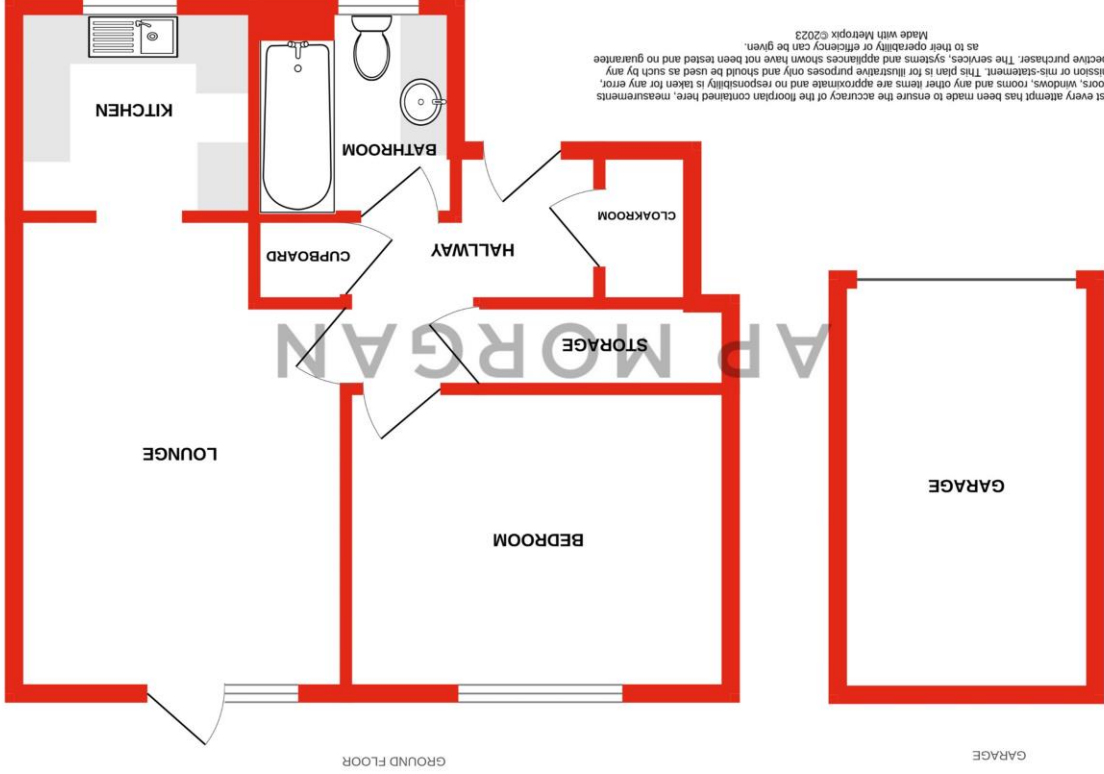

No statement in these details is to be relied upon as representation of fact, and purchasers should satisfy themselves by inspection or otherwise as to the accuracy of the statements contained within. These details do not constitute any part of any offer or contract. AP Morgan and their employees and agents do not have any authority to give any warranty or representation whatsoever in respect of this property. These details and all statements herein are provided without any responsibility on the part of AP Morgan or the vendors. Equipment: AP Morgan has not tested the equipment or central heating system mentioned in these particulars and the purchasers are advised to satisfy themselves as to the working order and condition. Measurements: Great care is taken when measuring, but measurements should not be relied upon for ordering carpets, equipment, etc. The Laws of Copyright protect this material. AP Morgan is the Owner of the copyright. This property sheet forms part of our database and is protected by the database right and copyright laws. No unauthorised copying or distribution without permission.